

PRODUCT DATA SHEET

SKP ECO TYPE CABLE LUG



DESCRIPTION

A cable lug is attached to an electrical device such as a wire or cable and then securely fastened to its end using a crimp tool and crimp die.

FEATURES

- Made of copper material in accordance with EN/13600 standards.
- Annealed copper pipes are used during production.
- Copper with 99.9% conductivity is used in production.
- 100% Tin coating is made in the range of 5-8 Microns.

MARKINGS



- It complies with CE standards.
- It complies with RoHS standards.
- It complies with ISO 9001 standards.
- It complies with IEC standards.
- It complies with TSE standards.
- Domestic Production.

PRODUCT DATA SHEET

SKP ECO TYPE CABLE LUG

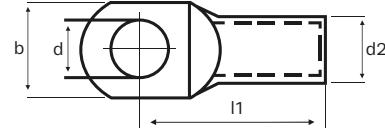
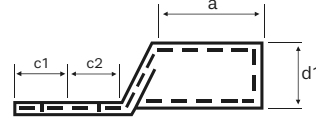

SECTIONS AND DIMENSIONS

ÜRÜN KODU	KABLO KESİT (mm ²)	DELİK ÇAPI Ø	BOYUTLAR							
			d	d1	d2	l1	a	b	c1	c2
SKP-E 95-10	95 mm ²	M10	10,3	13,5	16,0	48,5	21,0	23,5	10,0	12,0
SKP-E 95-12		M12	12,8	13,5	16,0	48,5	21,0	23,5	10,0	12,0
SKP-E 120-10	120 mm ²	M10	10,5	15,5	18,0	58,0	25,0	26,7	13,0	14,5
SKP-E 120-12		M12	12,8	15,5	18,0	58,0	25,0	26,7	13,0	14,5
SKP-E 150-10	150 mm ²	M10	10,5	16,5	20,0	59,5	26,0	29,2	16,5	16,5
SKP-E 150-12		M12	12,8	16,5	20,0	59,5	26,0	29,2	16,5	16,5
SKP-E 185-12	185 mm ²	M12	10,5	18,5	22,0	65,0	29,0	32,3	17,0	18,0
SKP-E 185-16		M16	16,5	18,5	22,0	65,0	29,0	32,3	17,0	18,0
SKP-E 240-12	240 mm ²	M12	13,0	21,5	25,5	74,0	33,0	37,6	17,0	18,0
SKP-E 240-16		M16	16,5	21,5	25,5	74,0	33,0	37,6	17,0	18,0